

LINE: ELECTRONIC SCALE  
 MODEL: EQ-5/10, EQ-10/20  
 BRAND: TORREY

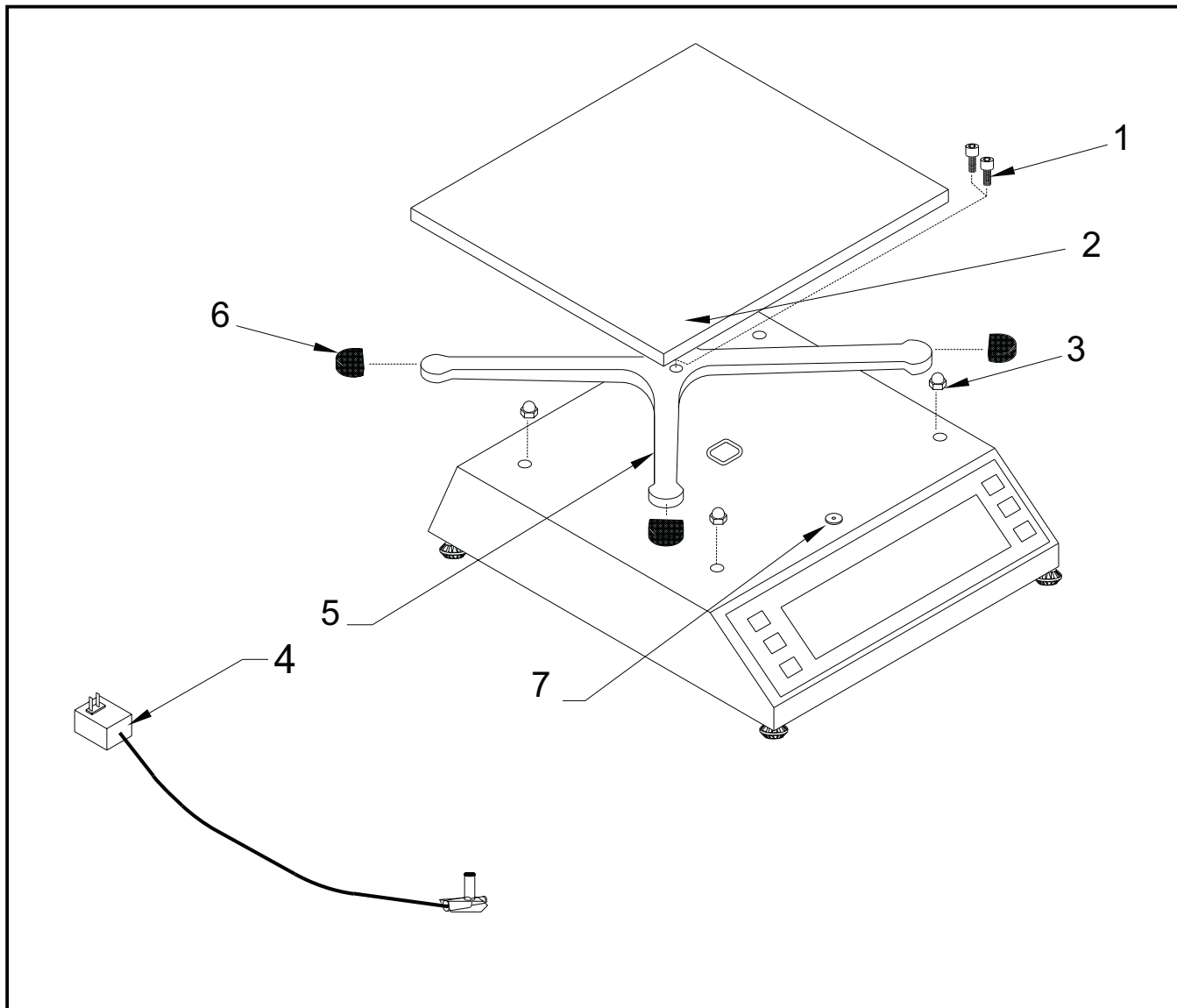

FROM THE SERIAL NUMBER:101



| No. | DESCRIPTION                                | CODE     | QTY. | R.S./100 |
|-----|--|----------|------|----------|
| 1   | 1/4 X 1 1/4 SOCKET CAP SCREW GALV.         | 12100049 | 2    | 4        |
| 2   | EQ/MEQ/MEQT PLATE                          | 36200008 | 1    | 2        |
| 3   | 5/32 CAP NUT CHROMED                       | 12100051 | 4    | 16       |
| 4   | AC/DC POWER SUPPLY 9V                      | 21900002 | 1    | 2        |
| 5   | MEQ ALUMINIUM PLATE HOLDER                 | 36100020 | 1    | 2        |
| 6   | E-10 PLATE HOLDER BUMPER                   | 12400022 | 4    | 8        |
| 7   | PLASTIC CIRCULAR LEVEL MODEL "C" ASSEMBLED | 46700001 | 1    | 2        |

R.S.= REQUIREMENT STOCK

LINE: ELECTRONIC SCALE  
 MODEL: EQ-5/10, EQ-10/20  
 BRAND: TORREY



FROM THE SERIAL NUMBER:1260

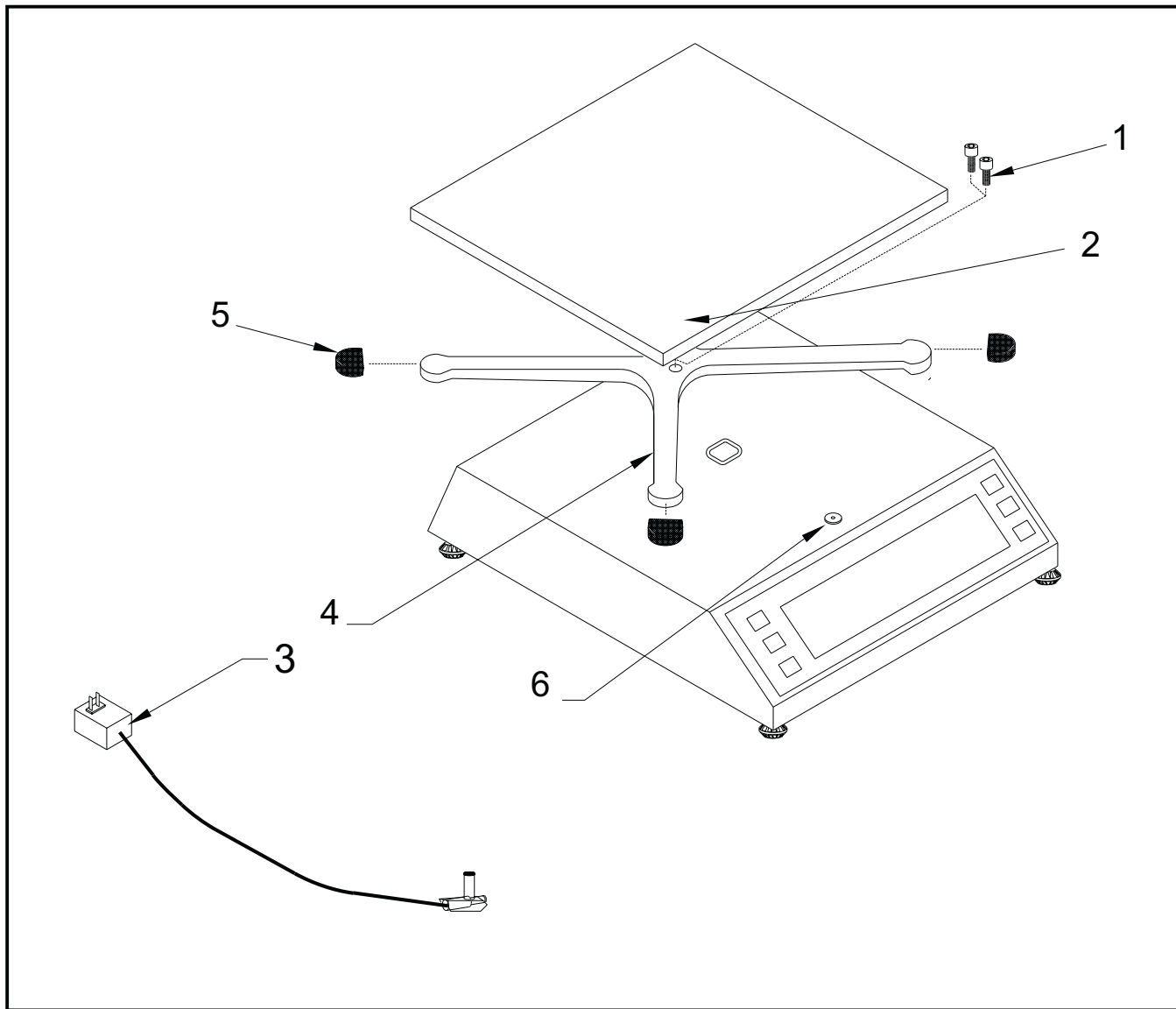

| No. | DESCRIPTION                                | CODE     | QTY. | R.S./100 |
|-----|--|----------|------|----------|
| 1   | 1/4 X 1 1/4 SOCKET CAP SCREW GALV.         | 12100049 | 2    | 4        |
| 2   | EQ/MEQ/MEQT PLATE                          | 36200008 | 1    | 2        |
| 3   | AC/DC POWER SUPPLY 9V                      | 21900002 | 1    | 2        |
| 4   | MEQ ALUMINIUM PLATE HOLDER                 | 36100020 | 1    | 2        |
| 5   | E-10 PLATE HOLDER BUMPER                   | 12400022 | 4    | 8        |
| 6   | PLASTIC CIRCULAR LEVEL MODEL "C" ASSEMBLED | 46700001 | 1    | 2        |

R.S.= REQUIREMENT STOCK

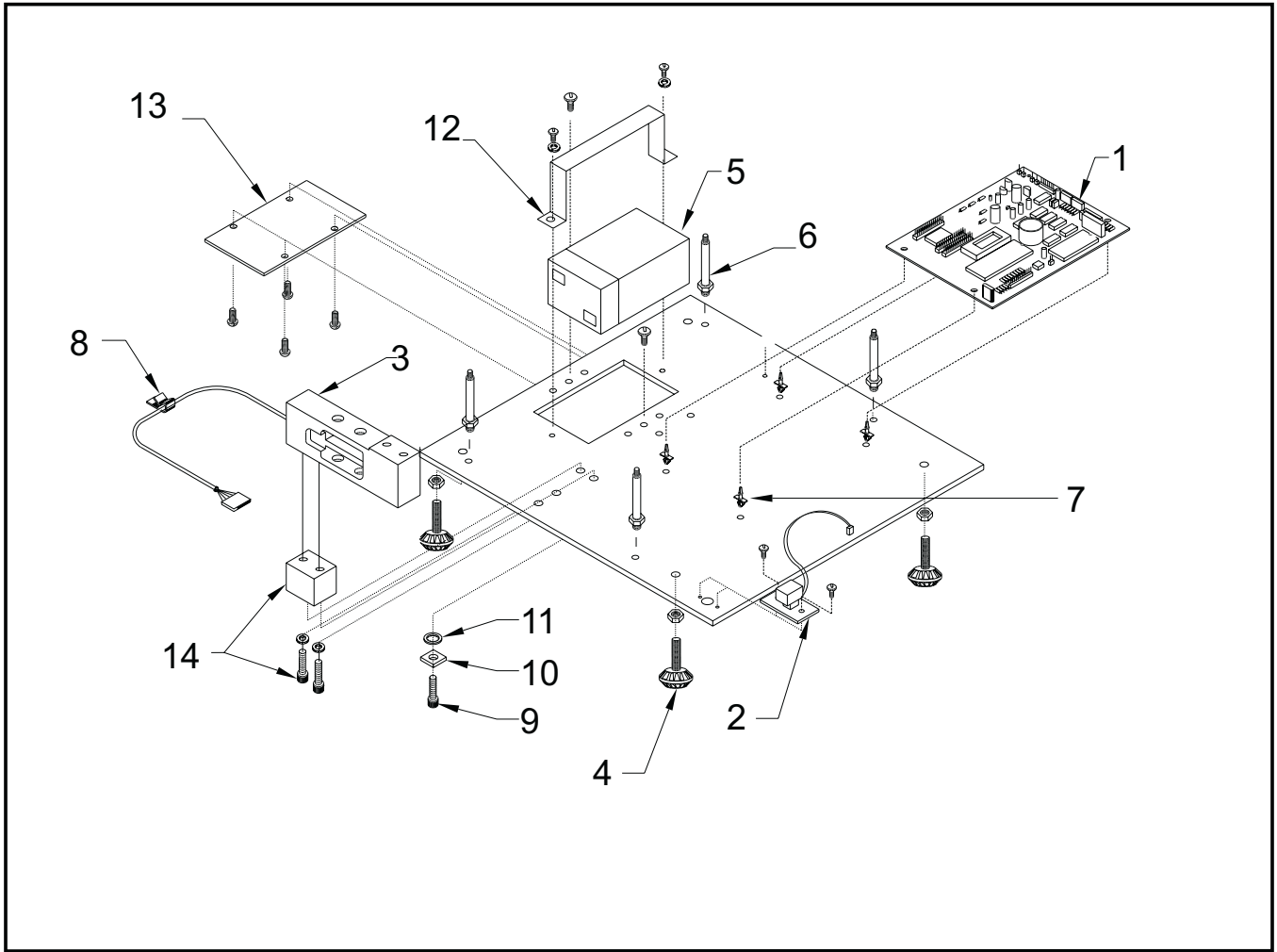

| No.                             | DESCRIPTION                                   | CODE     | QTY. | R.S./100 |
|---------------------------------|---|----------|------|----------|
| 1                               | MASTER BOARD TYPE MFQ FOR/EQ-5/10 ASSEMBLED   | 34500134 | 1    | 3        |
| 2                               | PLASTIC JACK ASSEMBLED                        | 46600001 | 1    | 3        |
| 3                               | WEIGHT SENSOR 5K/10LB                         | 46600232 | 1    | 3        |
| 4                               | LEVELIN BASE E-10                             | 36700057 | 4    | 12       |
| 5                               | RECHARGEABLE BATTERY 6V                       | 21900003 | 1    | 3        |
| 6                               | MEQ 1/4 STUD GALV.                            | 34400009 | 4    | 4        |
| 7                               | LOCKING CIRCUIT BOARD MEQ                     | 22400002 | 4    | 4        |
| 8                               | WIRE HARNESS CLAMP                            | 21900001 | 1    | 2        |
| 9                               | 1/4 X 1 SOCKET CAP SCREW GALV.                | 12100055 | 3    | 4        |
| 10                              | 1/4 SQR. NUT GALV.                            | 12100036 | 1    | 2        |
| 11                              | INTERNAL TOOTH WASHER                         | 22100002 | 1    | 2        |
| 12                              | BATTERY HOLDER                                | 36100022 | 1    | 2        |
| 13                              | BASE COVER WITH SCREW                         | 12400044 | 1    | 2        |
| 14                              | FITTING KIT 1041 MEQ, EQ                      | 36700008 | 1    | 2        |
| FROM THIS SERIAL NUMBER: B7 527 |   |          |      |          |
| 1                               | MASTER BOARD TYPE MFQB FOR/EQ-5/10 ASSEMBLED  | 46600134 | 1    | 3        |
| FOR EQ-10/20 MODEL              |   |          |      |          |
| 1                               | MASTER BOARD TYPE MFQ FOR/EQ-10/20 ASSEMBLED  | 46600291 | 1    | 3        |
| 3                               | WEIGHT SENSOR 10K/20LB                        | 46600033 | 1    | 3        |
| FROM THIS SERIAL NUMBER: B7 354 |   |          |      |          |
| 1                               | MASTER BOARD TYPE MFQB FOR/EQ-10/20 ASSEMBLED | 46600126 | 1    | 3        |

R.S.= REQUIREMENT STOCK

LINE: ELECTRONIC SCALE  
 MODEL: EQ-5/10, EQ-10/20  
 BRAND: TORREY FROM THE SERIAL NUMBER:1260

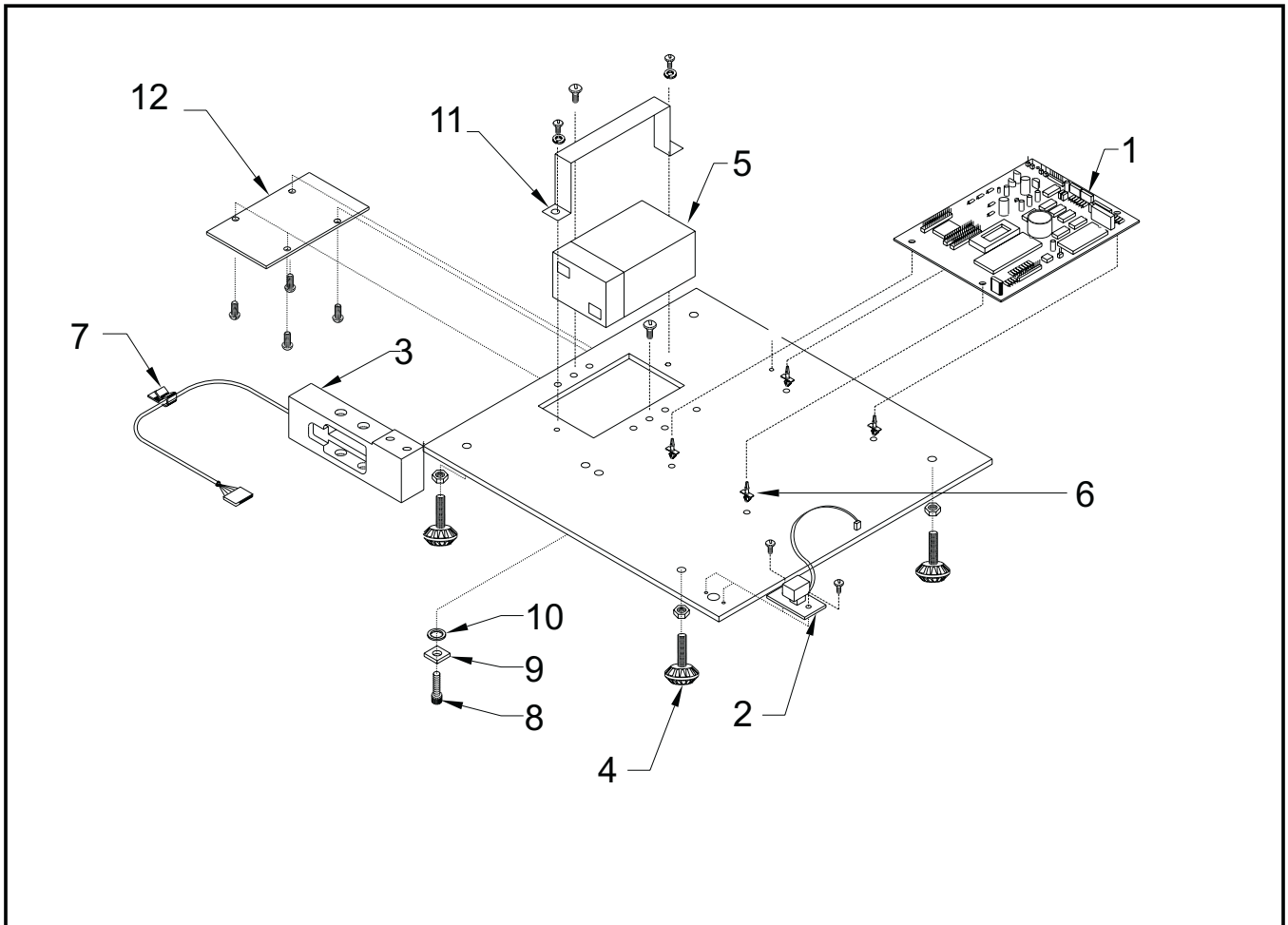

| No. | DESCRIPTION                                 | CODE     | QTY. | R.S./100 |
|-----|---|----------|------|----------|
| 1   | MASTER BOARD TYPE MFQ FOR/EQ-5/10 ASSEMBLED | 46600134 | 1    | 3        |
| 2   | PLASTIC JACK ASSEMBLED                      | 46600001 | 1    | 3        |
| 3   | WEIGHT SENSOR 5K/10LB                       | 46600063 | 1    | 3        |
| 4   | LEVELIN BASE E-10                           | 12400089 | 4    | 12       |
| 5   | RECHARGEABLE BATTERY 6V                     | 21900003 | 1    | 3        |
| 6   | LOCKING CIRCUIT BOARD MEQ                   | 22400002 | 4    | 4        |
| 7   | WIRE HARNESS CLAMP                          | 21900001 | 1    | 2        |
| 8   | 1/4 X 1 SOCKET CAP SCREW GALV.              | 12100254 | 3    | 4        |
| 9   | 1/4 SQR. NUT GALV.                          | 12100036 | 1    | 2        |
| 10  | INTERNAL TOOTH WASHER                       | 22100002 | 1    | 2        |
| 11  | BATTERY HOLDER                              | 21900003 | 1    | 2        |
| 12  | BASE COVER WITH SCREW                       | 12400044 | 1    | 2        |

FROM THIS SERIAL NUMBER: B7 527

|   |  |          |   |   |
|---|--|----------|---|---|
| 1 | MASTER BOARD TYPE MFQB FOR/EQ-5/10 ASSEMBLED | 46600134 | 1 | 3 |
|---|--|----------|---|---|

FOR EQ-10/20 MODEL

|   |  |          |   |   |
|---|--|----------|---|---|
| 1 | MASTER BOARD TYPE MFQ FOR/EQ-10/20 ASSEMBLED | 46600129 | 1 | 3 |
| 3 | WEIGHT SENSOR 10K/20LB                       | 46600033 | 1 | 3 |

R.S.= REQUIREMENT STOCK

LINE: ELECTRONIC SCALE  
 MODEL: EQ-5/10, EQ-10/20  
 BRAND: TORREY



FROM THE SERIAL NUMBER:  
 B7527 (EQ-5/10), B7354 (EQ-10/20)

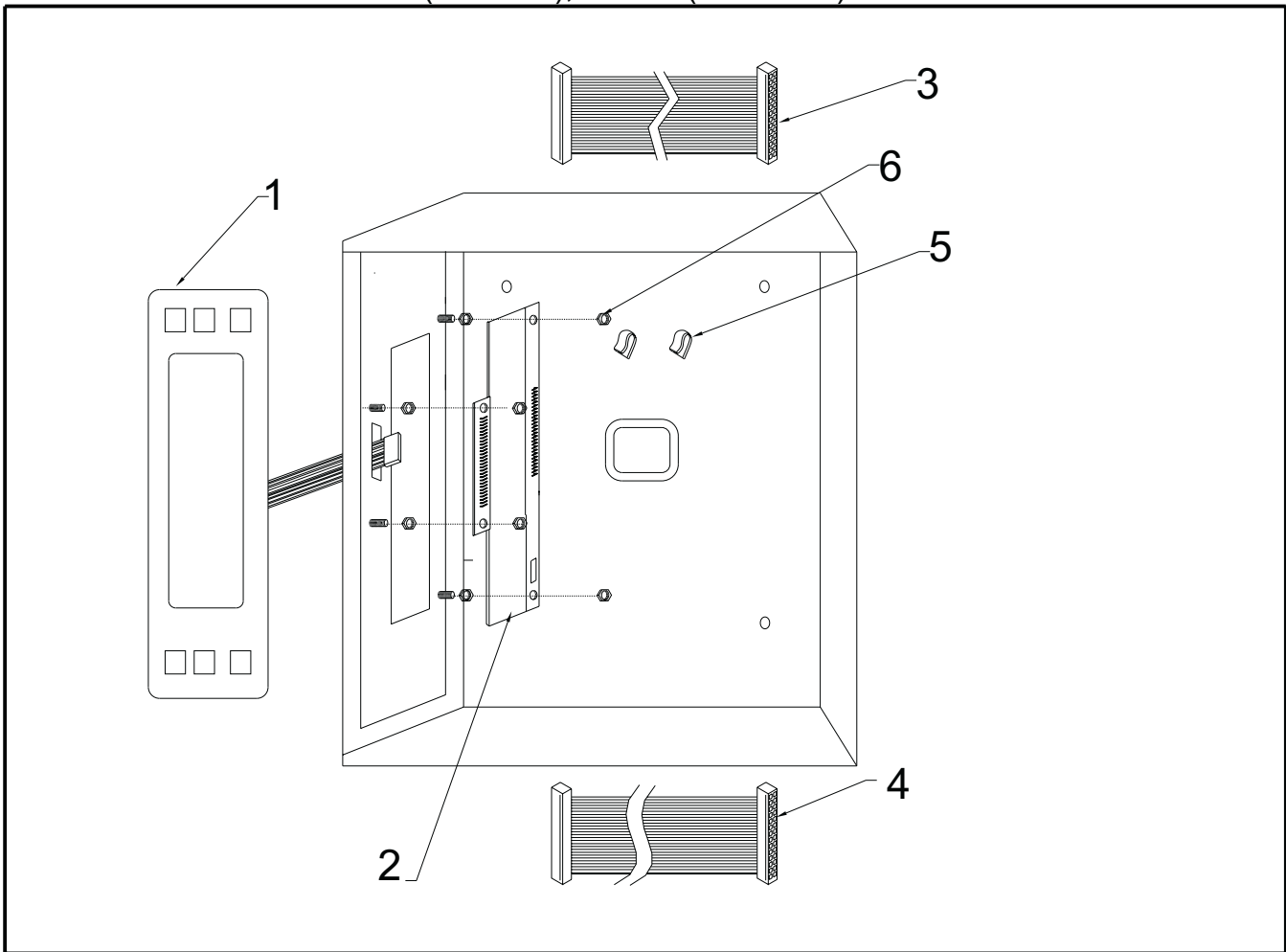

| NO.  | DESCRIPTION                     | CODE     | QTY. | R.S./100 |
|--|---------------------------------|----------|------|----------|
| 1  | MEMBRANE SWITCH EQ-5/10         | 20200011 | 1    | 2        |
| 1  | MEMBRANE SWITCH EQ-10/20        | 20200012 | 1    | 2        |
| 2  | DIGIT BOARD EQ                  | 46600124 | 1    | 2        |
| 3  | MASTER - DIGITS UNIV. HARNESS   | 46600363 | 1    | 2        |
| 5  | WIRE HARNESS CLAMP              | 21900001 | 2    | 8        |
| 6  | 8-32 PLASTIC HEX NUT            | 22400001 | 8    | 32       |
| FROM THIS SERIAL NUMBER: B7 527 (EQ-5/10)  |                                 |          |      |          |
| B7 354 (EQ-10/20)                          |                                 |          |      |          |
| 2  | DISPLAY EQB/EQM W/BACKLIGHT LED | 46600348 | 1    | 2        |
| 3  | DISPLAY 30 L/30 CM HARNESS      | 46600131 | 1    | 2        |
| 4  | DISPLAY EQ 10/20 LOWER HARNESS  | 46600132 | 1    | 2        |
| FROM THIS SERIAL NUMBER: D8 1605 (EQ-5/10) |                                 |          |      |          |
| D8 741 (EQ-10/20)                          |                                 |          |      |          |
| 2  | DISPLAY EQB/EQM W/BACKLIGHT EL  | 46600102 | 1    | 2        |

R.S.= REQUIREMENT STOCK

LINE: ELECTRONIC SCALE  
 MODEL: EQ-5/10, EQ-10/20  
 BRAND: TORREY



FROM THE SERIAL NUMBER:  
 D81605 (EQ-5/10), D8741 (EQ-10/20)

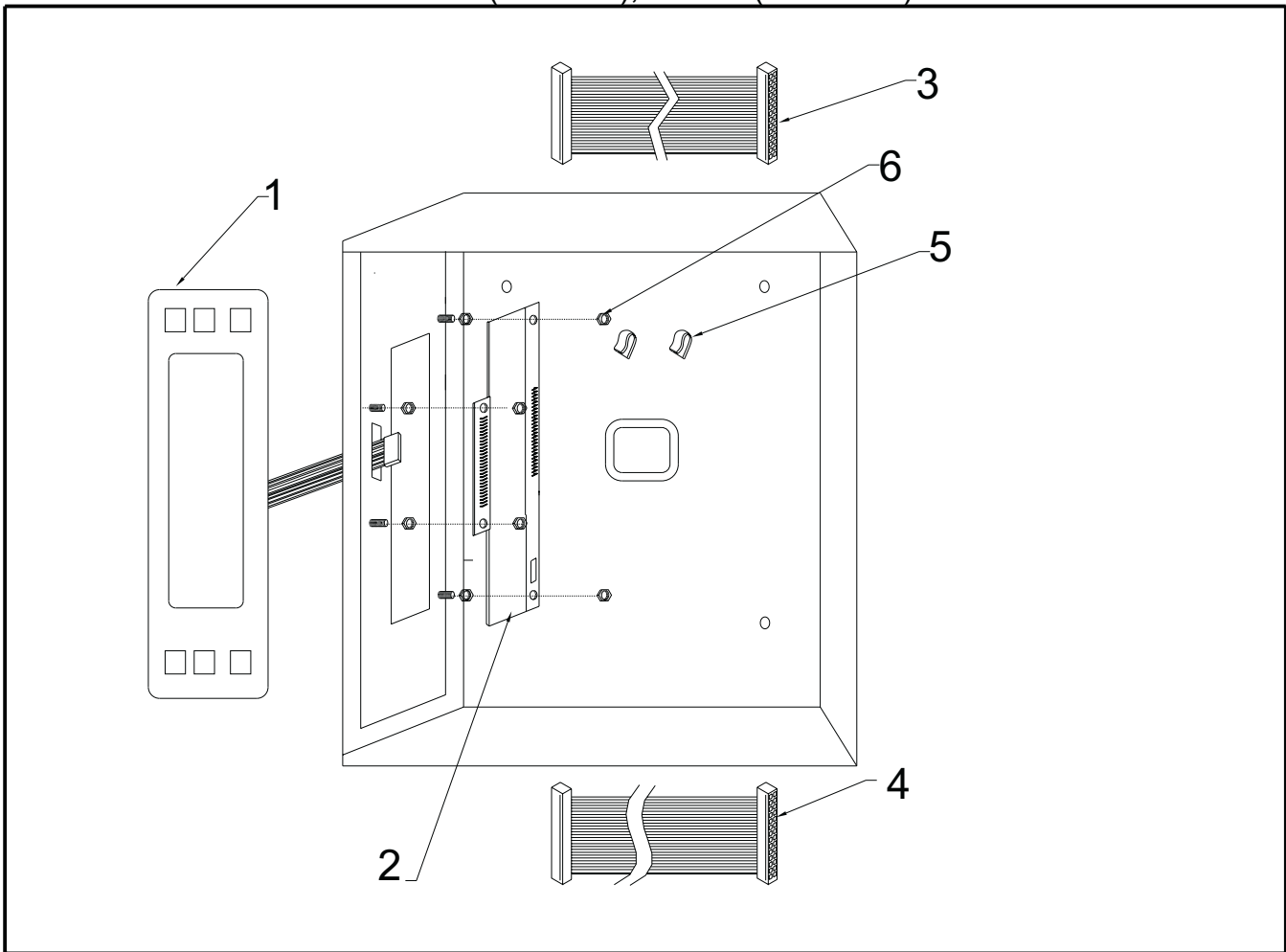

| NO.  | DESCRIPTION                     | CODE     | QTY. | R.S./100 |
|--|---------------------------------|----------|------|----------|
| 1  | MEMBRANE SWITCH EQ-5/10         | 20200011 | 1    | 2        |
| 1  | MEMBRANE SWITCH EQ-10/20        | 20200012 | 1    | 2        |
| 2  | DIGIT BOARD EQ                  | 46600130 | 1    | 2        |
| 3  | MASTER - DIGITS UNIV. HARNESS   | 46600363 | 1    | 2        |
| 5  | WIRE HARNESS CLAMP              | 21900001 | 2    | 8        |
| 6  | 8-32 PLASTIC HEX NUT            | 22400001 | 8    | 32       |
| FROM THIS SERIAL NUMBER: B7 527 (EQ-5/10)  |                                 |          |      |          |
| B7 354 (EQ-10/20)                          |                                 |          |      |          |
| 2  | DISPLAY EQB/EQM W/BACKLIGHT LED | 46600348 | 1    | 2        |
| 3  | DISPLAY 30 L/30 CM HARNESS      | 46600131 | 1    | 2        |
| 4  | DISPLAY EQ 10/20 LOWER HARNESS  | 46600132 | 1    | 2        |
| FROM THIS SERIAL NUMBER: D8 1605 (EQ-5/10) |                                 |          |      |          |
| D8 741 (EQ-10/20)                          |                                 |          |      |          |
| 2  | DISPLAY EQB/EQM W/BACKLIGHT EL  | 46600102 | 1    | 2        |

R.S.= REQUIREMENT STOCK